

### GEZE Perlan 140 KS

#### The sliding fitting for maximum use

The GEZE Perlan 140 KS is based on the tried-and-tested sliding fitting system Perlan 140. It is a high-quality, corrosion-resistant product version for door leaves of up to 140 kg, and fulfils the standard of the highest corrosion protection class in accordance with DIN EN 1670. GEZE thus offers a sliding fitting for external use, too, which can be used even under extreme environmental conditions such as sea air or chemical environment. Like the standard system, Perlan KS can be combined with the Perlan accessories range. The sliding fitting meets all the requirements of the valid standards with regard to statistical loads, suitability for use, operating force and corrosion resistance.



Kado Karim luxury residential complex, Jurmala, Latvia (photo: Aleksandrs Kendenkovs)

### APPLICATION RANGE

- Particularly suited for automatic and manual shading systems for external use
- Can be combined with Perlan AUT (heed corrosion protection)
- For other applications (e.g. in swimming pools) where increased corrosion protection is required in the fitting
- All other product features correspond to the Perlan 140 roller-guided sliding system

## TECHNICAL DATA

Product features	GEZE Perlan 140 KS
Leaf material	Wood, plastic, metal
Leaf weight (max.)	140 kg
Number of leaves	1-leaf, 2-leaf
Corrosion protection class	4
Type of installation	Wall installation, ceiling installation
Automated	•
Fixed panel	•

• = yes

### Classification in accordance with DIN EN 1527

GEZE Perlan 140 KS Fitting								
Usage category	Permanent functionality	Door weight	Fire resistance	Safety	Corrosion resistance	Protection	Door type	Initial friction
-	6	3	-	1	4	-	1	3

The description of the classes can be found at the end of the catalogue.

### Standard dimensions in mm

Leaf width (FB)	Track length (L)	Distance between drill holes (t)	Number of drill holes (n)	Distance from first drill hole (centre) to end of track (y)
500 - 840	1650	350	5	125
500 - 1040	2050	350	6	150
500 - 1240	2450	350	7	175
500 - 1440	2850	350	9	25
500 - 1640	3250	350	10	50
Stock length (LL)	6000	350	18	25

CROSS-SECTION DRAWINGS

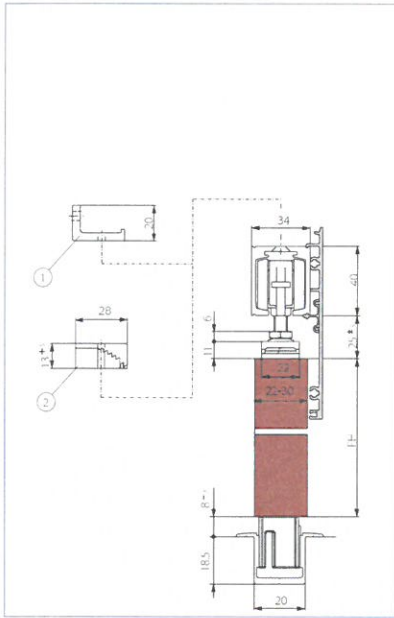

Wall / ceiling mounting glass with clip-on cover 100 one-sided

FH = Leaf height  
 1 = Wall bracket  
 2 = Height compensation mechanism

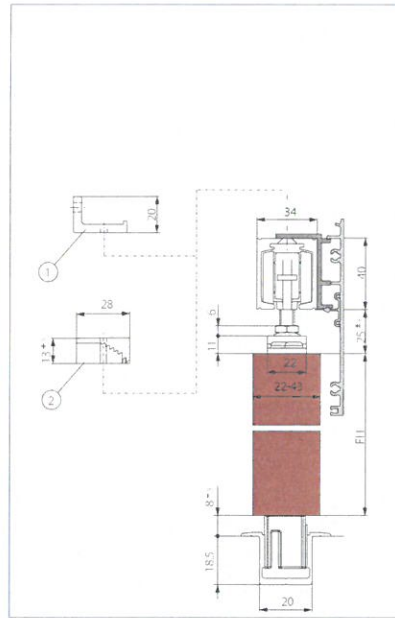

Wall / ceiling mounting wood with spacer bracket and clip-on cover 100

FH = Leaf height  
 1 = Wall bracket  
 2 = Height compensation mechanism

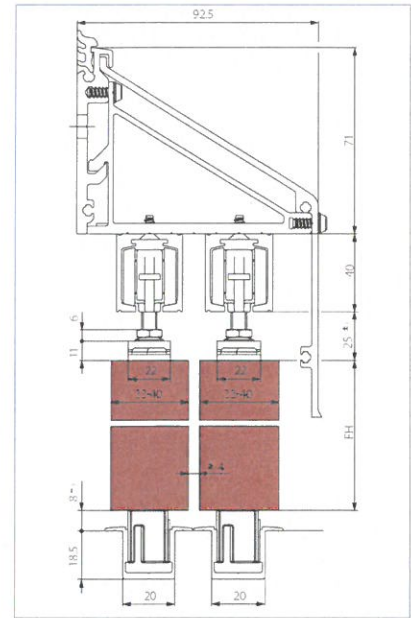

Wall / ceiling mounting wood with Perlan wall bracket and weather canopy

FH = Leaf height

ORDER INFORMATION

Description	Leaf width from - to	Length	Version	ID no.
Accessory set basic components Perlan 140 KS corrosion-protected for external use, for ceiling mounting, comprising: 2 x roller carriage, 2 x end stop, 2 x suspension plate, 1 x hold-open spring, 2 x suspension bolt, 2 x end cover	500 mm 1640 mm			119510
Accessory set basic components Perlan 140 KS corrosion-protected for external use, for wall mounting, comprising: 2 x roller carriage, 2 x end stop, 2 x suspension plate, 1 x hold-open spring, 2 x suspension bolt, 2 x end cover, incl. standard wall bracket (length = can be used up to track length)	500 mm 840 mm	1650 mm		119507
	500 mm 1240 mm	2450 mm		119508
	500 mm 1640 mm	3250 mm		119509
<b>Accessories</b>				
Suspension plate Perlan 140 KS corrosion-protected, for external use and in aggressive environments, without attachment material			stainless steel	117355
Wall bracket Perlan 140 KS corrosion-protected, for external use and in aggressive environments, with sliding block and fixing screw for track				119319
Roller carriage Perlan 140 KS without suspension bolt corrosion-protected, for external use and in aggressive environments, up to 140 kg leaf weight				117354
Roller carriage Perlan 140 KS with suspension bolt corrosion-protected, for external use and in aggressive environments, up to 140 kg leaf weight				120087
Suspension bolt Perlan 140 KS with combination nut			stainless steel	117357



Roller carriage



Suspension plate



Suspension bolt

## GEZE PERLAN 140 TELESCOPIC 3-LEAF

## GEZE Perlan 140 telescopic for 3-leaf external applications

GEZE Perlan 140 telescopic is the elegant, space-saving roller-guided sliding system for extensive and spacious passages. It offers reliable protection from sunlight in combination with sliding shutters. High-quality bearings and a sturdy track guarantee a greater life span. The telescope set can easily be pre-assembled on the sliding elements. Perlan 140 telescopic is available as a complete accessory set for a 2-leaf system. This contains all parts for the telescopic function. There is an extension set available for each further leaf. The GEZE installation tool or a sleeve tool is required for installation of the wire cable.



## APPLICATION RANGE

- For wooden, plastic and glass leaves
- For 2-leaf or 3-leaf systems of up to 140 kg per leaf
- Leaf width between at least 475 mm and 1700 mm per leaf
- All other product features correspond to the Perlan 140 roller-guided sliding system

## TECHNICAL DATA

Product features	GEZE Perlan 140 lower guides for sliding shutters
Leaf material	Wood, plastic, metal
Number of leaves	2-leaf, 3-leaf
Leaf weight (max.)	140 kg
Type of installation	Wall installation, ceiling installation
Telescope	•

• = yes

## GEZE PERLAN 140 TELESCOPIC 3-LEAF

### OVERVIEW OF COMPONENTS

#### GEZE Perlan 140 telescopic for sliding shutters with three leaves

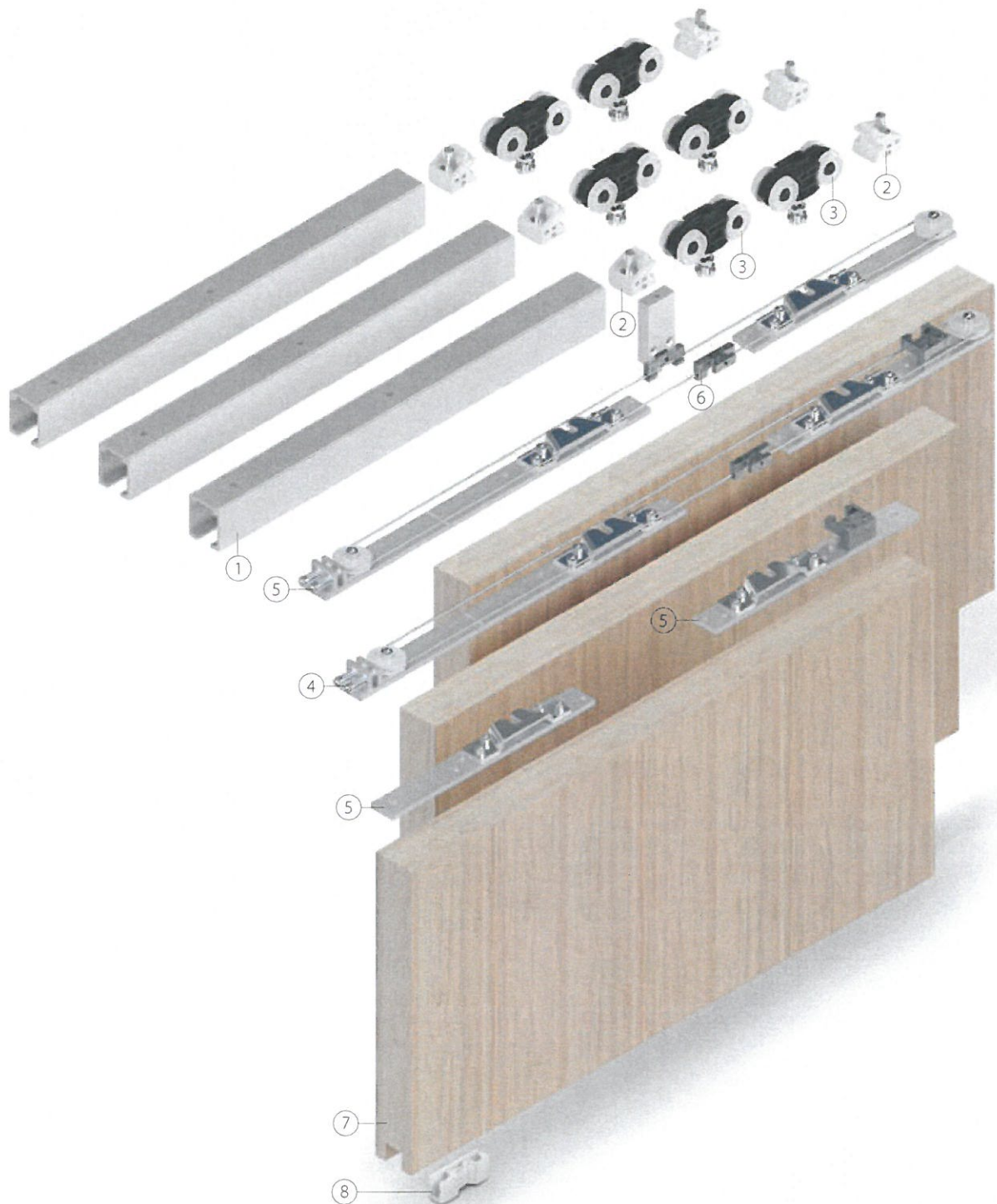

- 1 = Track Perlan 140
- 2 = End stop Perlan 140
- 3 = Roller carriage Perlan 140
- 4 = Fitting extension for telescope 3-leaf

- 5 = Fitting for telescope 2-leaf
- 6 = Wall/ceiling adapter for telescope
- 7 = Wooden leaf (on site)
- 8 = Clearance-free floor guide for wooden leaves

# GEZE PERLAN 140 TELESCOPIC 3-LEAF

## CROSS-SECTION DRAWINGS

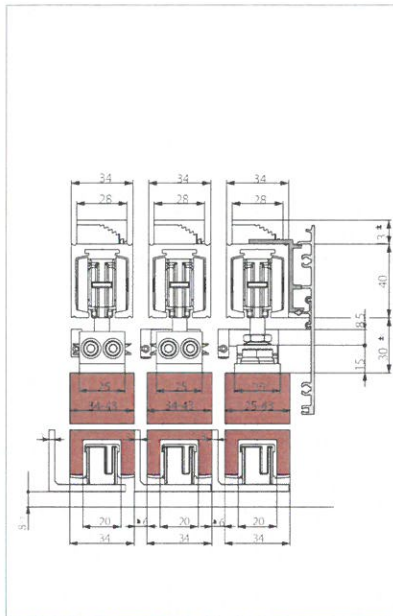

Ceiling mounting wood with spacer bracket and clip-on cover 100

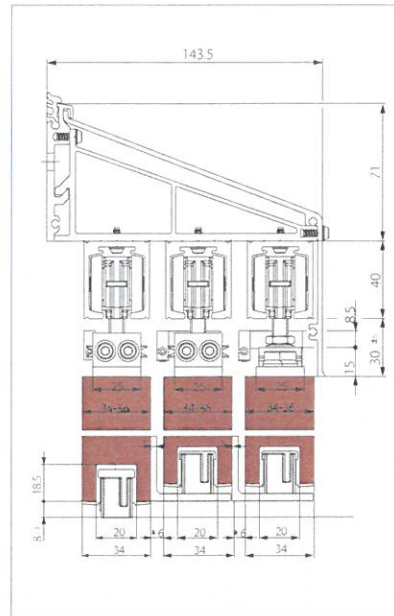

Wall mounting wood with wall bracket and weather canopy

## ORDER INFORMATION

Description	Length	Version	ID no.
Perlan telescope set, 2-leaf for the telescopic movement of wooden leaves, comprising: complete telescopic mechanism with mounting material, wire cable 3.8 m, including 4 x suspension plates Perlan 140 KS			130891
Perlan telescope set, extension 3-leaf for extension by a 3rd leaf, including 2 x suspension plate Perlan 140 KS			130892
<b>Accessories</b>			
Mounting tool for cable riveting for the riveting of the wire cable for the Perlan telescopic			134035
M shape floor guide	6000 mm	EV1	124661
Continuous Omega shape floor guide	6000 mm	EV1	124640
Clearance-free floor guide with attachment material			123514
Buffer for continuous floor guide			124655
Buffer for continuous glass floor guide			124656
100 mm grooved bracket for floor guide with attachment material			123513
40 mm grooved bracket for floor guide with attachment material			123511
60 mm grooved bracket for floor guide with attachment material			123512

# GEZE PERLAN AUT 2

## GEZE Perlan AUT 2

The GEZE Perlan AUT 2 set allows automation of the manual sliding fitting system Perlan 140 for leaf weights of up to 120 kg. The simple and cost-effective automatic opening and closing system offers numerous application possibilities: from walk-in wardrobes to sliding shutters.

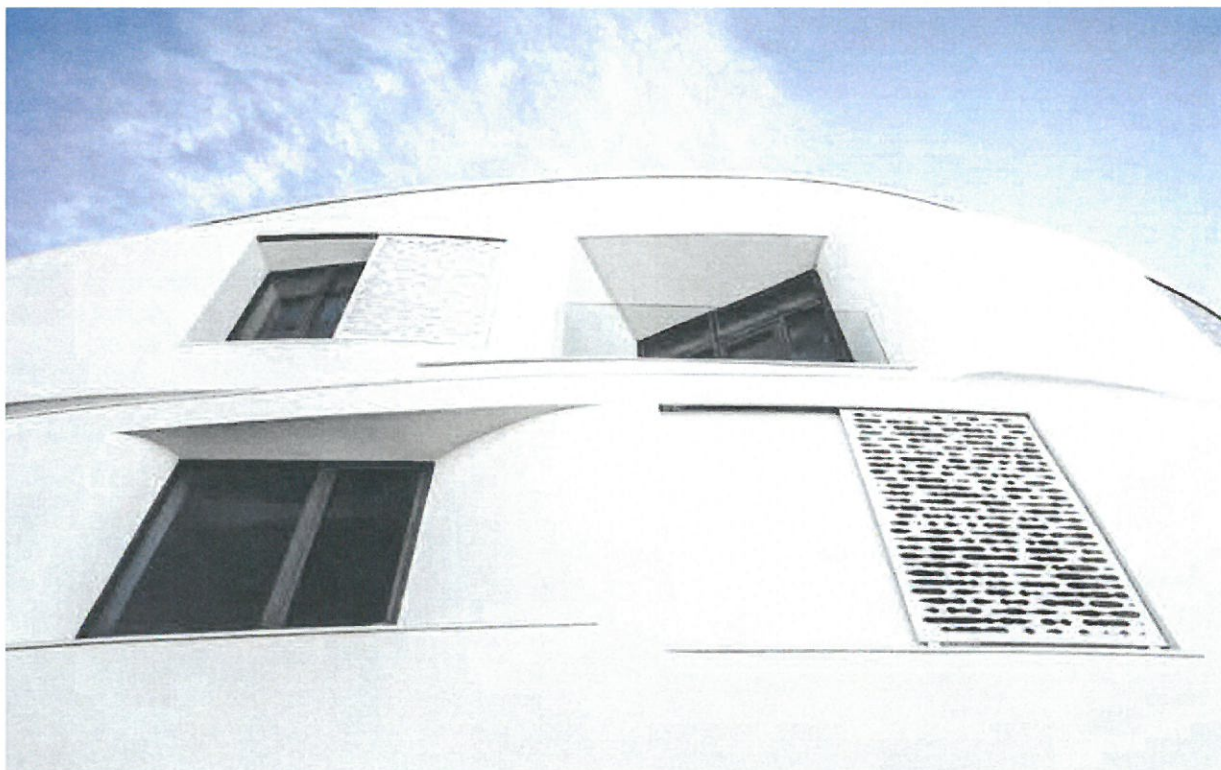

Kado Karim luxury residential complex, Jurmala, Latvia (photo: Aleksandrs Kendenkovs)

### APPLICATION RANGE

- E.g. for walk-in wardrobes or sliding shutters in external areas
- For leaf weights of up to 120 kg
- For 1- or multiple-leaf systems
- Suitable for connection to a building system using potential-free actuators

### TECHNICAL DATA

Product features	GEZE Perlan AUT 2
Leaf material	Wood, plastic, metal, glass
Leaf weight (max.)	120 kg
Number of leaves	1-leaf, 2-leaf
Type of installation	Wall installation, ceiling installation
Automated	•

• = yes

#### Note

The wall recesses must be made accessible by a removable cover. The door leaf must be stopped in addition – except with the end stop – by a further leaf stop. The buffer must be attached in the middle of the door height.

OVERVIEW OF COMPONENTS

**GEZE Perlan 140 AUT 2 wooden leaf wall mounting with suspension plate and clip-on cover 100**

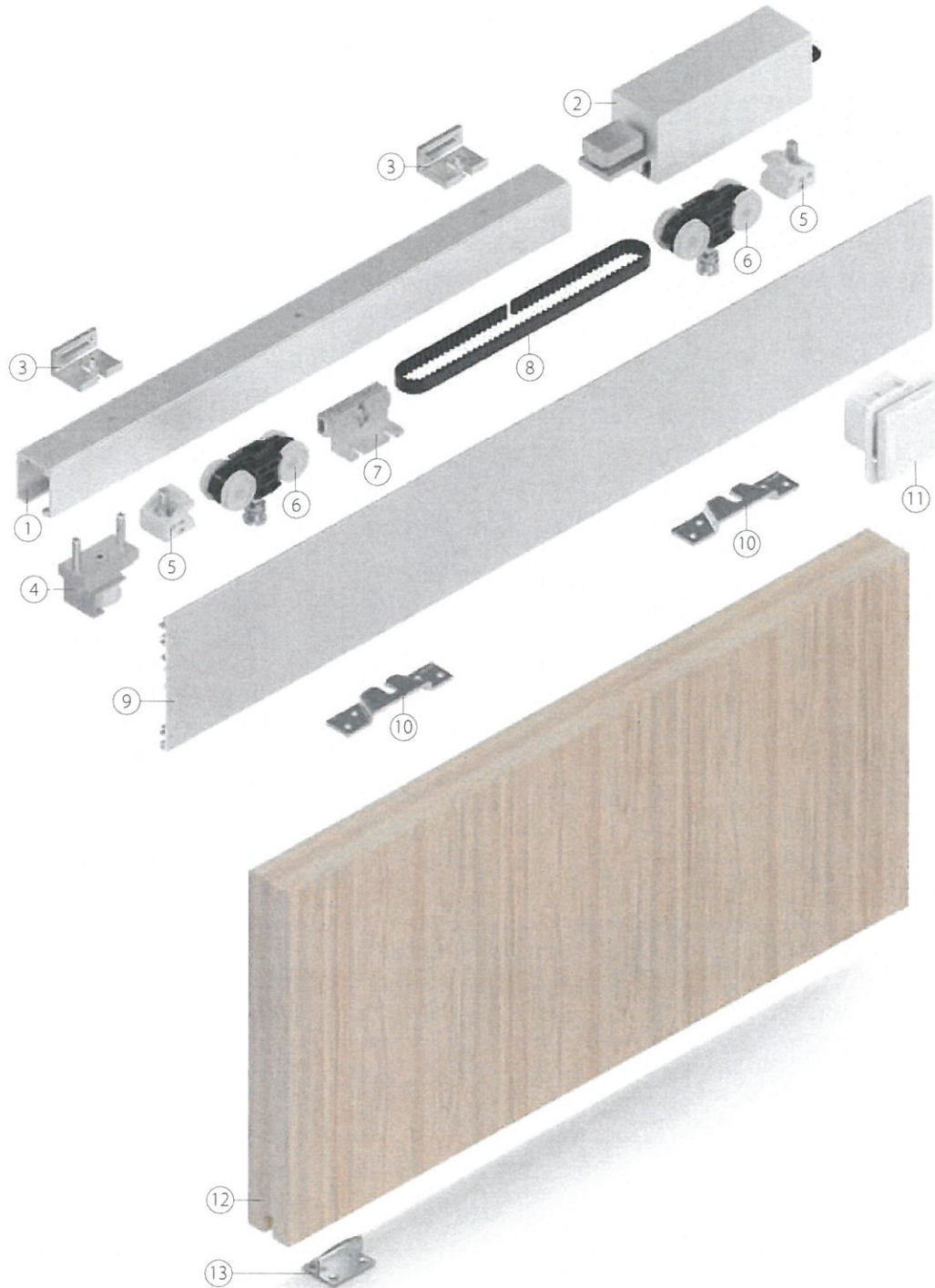

- |                                |  |
|--------------------------------|--|
| 1 = Track Perlan 140           | 8 = Toothed belt   |
| 2 = Drive Perlan AUT 2         | 9 = Clip-on cover 100  |
| 3 = Wall bracket Perlan 140    | 10 = Suspension plate Perlan 140                               |
| 4 = Return pulley              | 11 = Push button with control unit and integrated power supply |
| 5 = End stop Perlan 140        | 12 = Wooden leaf (on site)                                     |
| 6 = Roller carriage Perlan 140 | 13 = Floor guide for wooden leaf                               |
| 7 = Driver wooden leaf         |  |

Fixture can be made either direct or using a plate on the ceiling or a bracket on the wall.

# GEZE PERLAN AUT 2

## CROSS-SECTION DRAWINGS

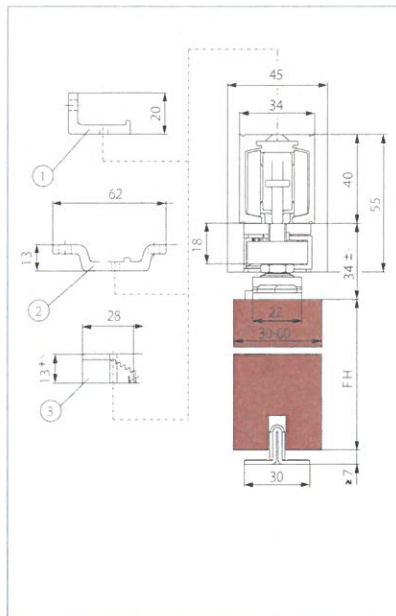

Wall / ceiling mounting wood

- FH = Leaf height  
 1 = Wall bracket  
 2 = Ceiling bracket  
 3 = Height compensation mechanism

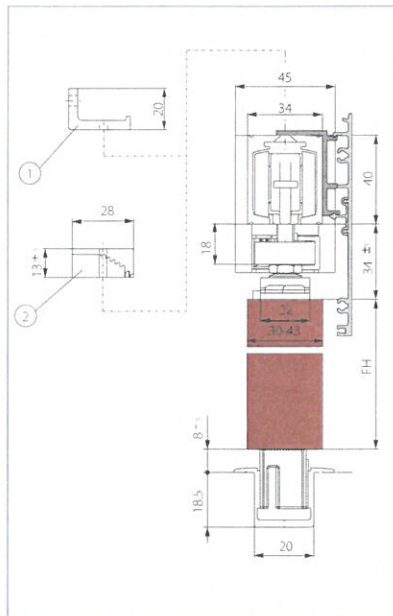

Wall / ceiling mounting wood with spacer bracket and clip-on cover 100 one-sided

- FH = Leaf height  
 1 = Wall bracket  
 2 = Height compensation mechanism

## ORDER INFORMATION

Description	Length	ID no.
Perlan AUT 2 set for sliding shutters for the automation of sliding shutters up to 120 kg leaf weight, comprising: 1 x motor, 1 x toothed belt 12.5 m, 1 x driver for wood, 1 x return pulley, 1 x push button incl. control unit		147543
<b>Accessories</b>		
Driver wood for Perlan AUT-NT / AUT 2 / Duosync, including 2 x elongated suspension bolts		134280
Perlan AUT additional switch (without control)		126181
Perlan AUT-NT / AUT 2 toothed belt	78000 mm	141500
Perlan AUT-NT / AUT 2 toothed belt, bespoke		141561

## GEZE PERLAN 140 WALL BRACKET WITH WEATHER CANOPY

### GEZE Perlan 140 wall bracket with weather canopy

The GEZE Perlan 140 wall bracket with weather canopy is used in external areas to mount sliding shutters. It supports up to three Perlan 140 tracks safely and reliably. Brackets are available in three sizes for this. The maximum load bearing capacity is 420 kg/m. This means a maximum leaf weight of 140 kg with three parallel sliding shutters. All parts are made of corrosion-protected material and are suitable for external use. The tracks can be pre-assembled with the brackets completely on the ground, preventing tiring overhead work to a major extent. The system is then simply hooked into the previously installed wall profile and secured using screws. The wall bracket with weather canopy can be provided as a bespoke set on request. Alternatively, all profiles and accessory parts can be purchased individually. The cover profile is available with a silver-coloured or stainless steel optic finish, or can be delivered in all RAL colours upon request.

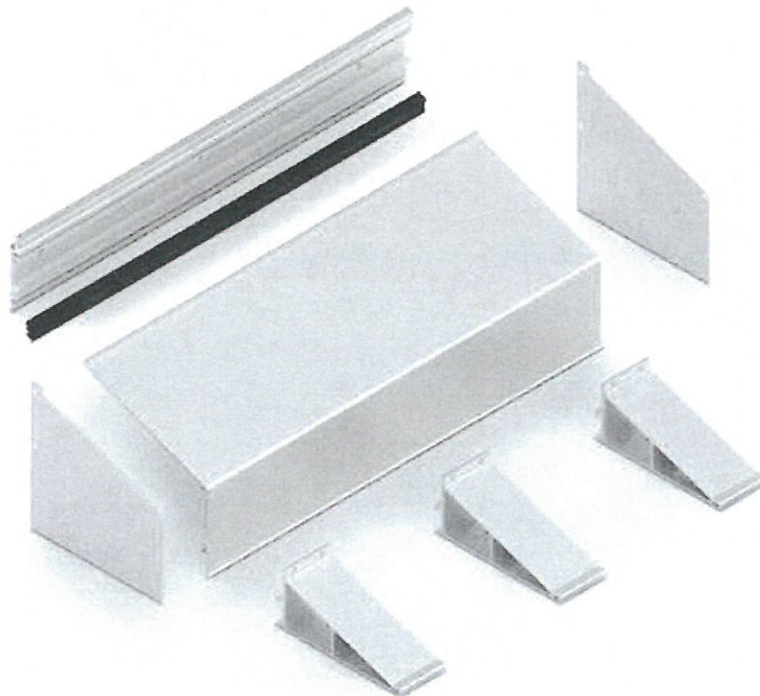

### APPLICATION RANGE

- For sliding shutters in external areas
- For 1 to 3 Perlan 140 tracks
- For 1 to 3 parallel sliding elements with up to 140 kg leaf weight
- Suitable as weather protection for Perlan AUT 2

### TECHNICAL DATA

Product features	GEZE Perlan 140 wall bracket with weather canopy
Leaf material	Wood, plastic, metal, glass
Number of leaves	1-leaf, 2-leaf, 3-leaf
Type of installation	Wall installation
Automated	•

• = yes

## GEZE PERLAN 140 WALL BRACKET WITH WEATHER CANOPY

### OVERVIEW OF COMPONENTS

#### GEZE Perlan 140 wall bracket with weather canopy

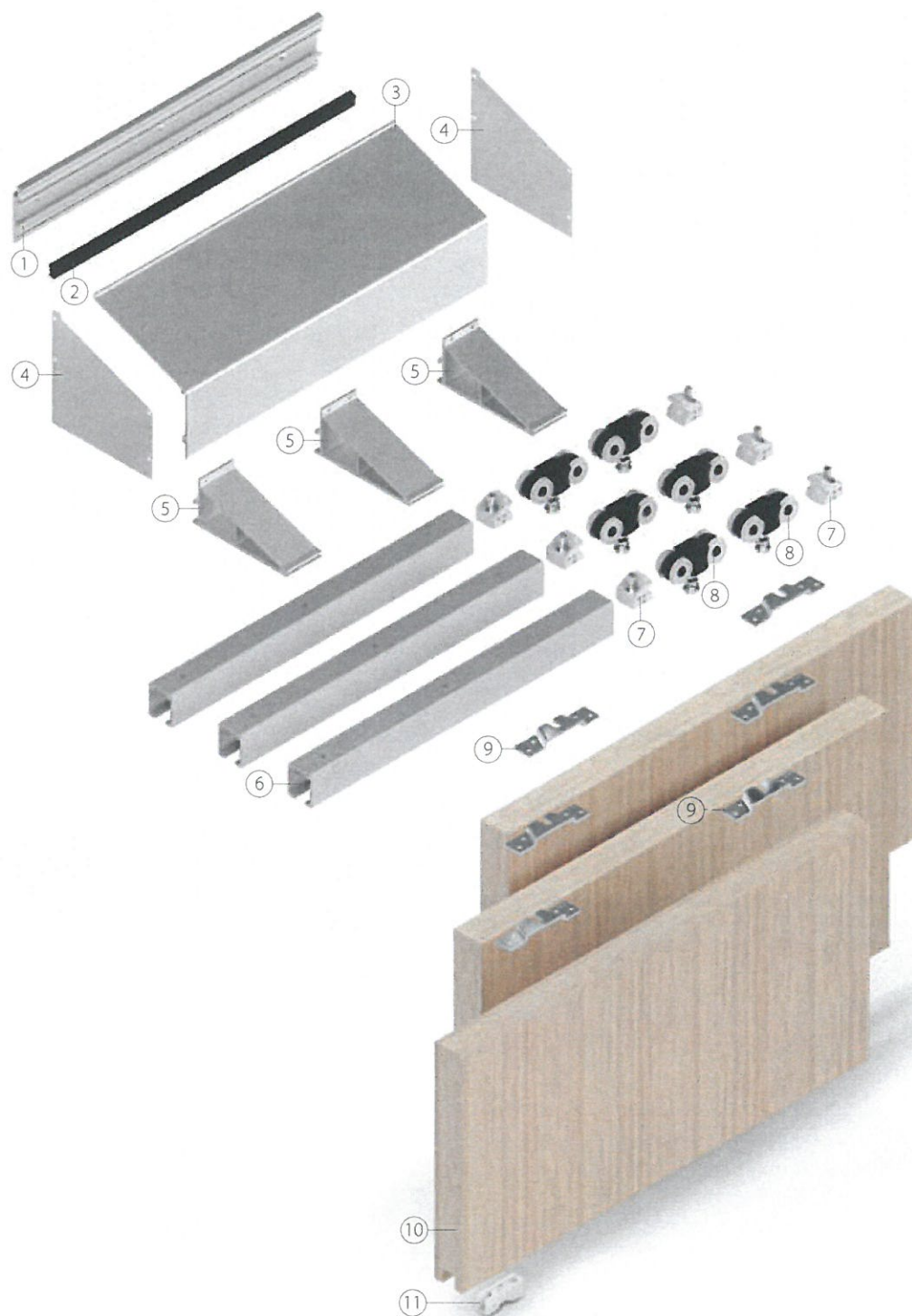

- |   |   |    |  |
|---|---|----|--|
| 1 | = Wall attachment profile Perlan 140              | 7  | = End stop Perlan 140                        |
| 2 | = Seal wall connection                            | 8  | = Roller carriage Perlan 140                 |
| 3 | = Cover profile for wall installation Perlan 140  | 9  | = Suspension plate Perlan 140                |
| 4 | = End cover for wall installation Perlan 140      | 10 | = Wooden leaf (on site)                      |
| 5 | = Fixing bracket for wall installation Perlan 140 | 11 | = Clearance-free floor guide for wooden leaf |
| 6 | = Track Perlan 140                                |    |  |

## GEZE PERLAN 140 WALL BRACKET WITH WEATHER CANOPY

## CROSS-SECTION DRAWINGS

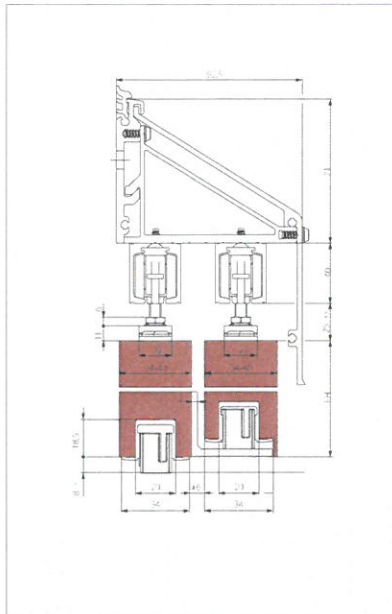

Wall bracket and weather canopy, wood, medium variant, example 2-leaf

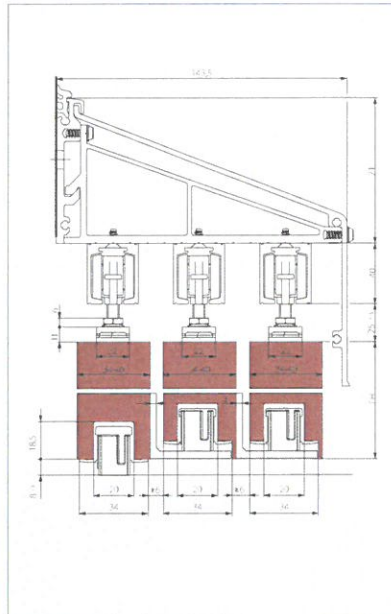

Wall bracket weather canopy, wood, long variant example 3-leaf

## ORDER INFORMATION

Description	Length	Version	ID no.
Short cover	6000 mm	EV1	127264
Short cover		EV1	127265
Short cover bespoke		acc. to RAL	127674
Medium cover	6000 mm	EV1	127266
Medium cover bespoke		acc. to RAL	127675
Long cover	6000 mm	EV1	127268
Long cover		EV1	127269
Long cover bespoke		acc. to RAL	127676
Wall attachment profile, perforated	6000 mm	EV1	127259
Wall attachment profile, perforated		EV1	127260
Wall attachment profile, perforated bespoke		acc. to RAL	127673
Fixing bracket set, short with fixing screws for ceiling and cover profile		EV1	127320
Fixing bracket set, long with fixing screws for ceiling and cover profile		EV1	127323
Fixing bracket set, medium with fixing screws for ceiling and cover profile		EV1	127322
Wall installation set Perlan 140 bespoke			127582
<b>Accessories</b>			
Seal wall connection for use with Perlan „concealed wall bracket up to 43 mm“ or „basic profile wall installation external use“	200000 mm	black	127311
Seal wall connection bespoke, for use with Perlan „concealed wall bracket up to 43 mm“ or „basic profile wall installation external use“		black	127731
End cover set, short 2 pcs., with fixing screws		EV1	127313
		acc. to RAL	127317
End cover set, long 2 pcs., with fixing screws		EV1	127316
		acc. to RAL	127319
End cover set, medium 2 pcs., with fixing screws		EV1	127314
		acc. to RAL	127318

## Product information

### Product information for sliding door systems

In compliance with the liability the manufacturer has for its products under the German product liability law (§ 4 Prod-HG), the following information regarding sliding door systems must be observed. Failure to comply releases the manufacturer from his statutory liability.

### Product information and intended use

Sliding door fittings in this definition are fittings for sliding leaves and similar sliding elements, called "objects" below, that are usually not moved faster than at walking speed. Sliding fittings are used at perpendicularly mounted leaves made of wood, plastic, glass, aluminium or steel and their corresponding material combinations. A floor guide is provided at the lower horizontal sides of the leaves. Products in special versions must be specified for wet rooms, for direct exposure to the weather, in cross-winds, near the sea or for use in aggressive, corrosive environments. Intended use includes proper installation in particular. The fitting has to be sufficiently stable in all positions. Functioning of the fitting must not be impaired or modified by installation. Buffers have to be used to limit the range of movement.

### Misuse

Misuse – meaning any use that is not the proper use – of sliding door fittings exists in particular when

- the fittings are used with a higher load than the maximum load bearing capacity that is specified in the catalogue and in the remaining product documentation,
- improper installation or insufficient fastening has taken place,
- excessively high or low ambient temperature prevail,
- particularly aggressive media can act on them,
- inappropriately rough bump and fall loads act on them,
- the position of the track deviates too strongly from the horizontal,
- foreign material can penetrate the track,
- the carrier rollers are used with excessive speed,
- modifications were carried out that were not agreed with the manufacturer,
- obstructions are inserted into the opening area or between the leaves or the object, thus preventing its proper use,
- additional loads act on leaves or the object,
- there is an intervention between the leaf and the masking frame when the leaf is closed or when closing or if a person or a body part is located within this area when the leaf is closed.

### Product performance

If the product performance is not specified in concrete forms in our catalogues, brochures, technical specifications and other product instructions, the requirements placed on our fittings have to be agreed with us. Our regulations dealing with the assembly of the fittings are binding.

### Product care and maintenance

Safety-relevant fitting parts must be checked regularly for firm seating and wear & tear. Depending on the requirements, the fixing screws are to be tightened or replaced respectively. In addition, the following service and maintenance work has to be carried out at least once a year:

- Check the functionality of all the moving parts.
- Use only such detergents that do not impair the anti-corrosion protection of the fittings.
- Faulty fittings must be replaced.
- Adjusting work at the fittings as well as the exchange of the fittings must be carried out by a specialist company.

### Duties to provide information and instructions

The following resources are available to help planners, specialist suppliers, installers, builders and users fulfil their duties of information and instruction:

- Catalogues, brochures
- Tender texts, bidding documents
- Installation and mounting instructions, installation drawings

In order to ensure the correct use, to ensure the function and the maintenance and care of the fittings

- architects and planners are advised to order and observe the necessary product information
- specialist suppliers are advised to observe the product information and advice in the price lists and, in particular, to order all relevant instructions, which are to be passed on to the fabrication companies
- fabrication companies are advised to observe all the product information and to pass it on to the client and user.